

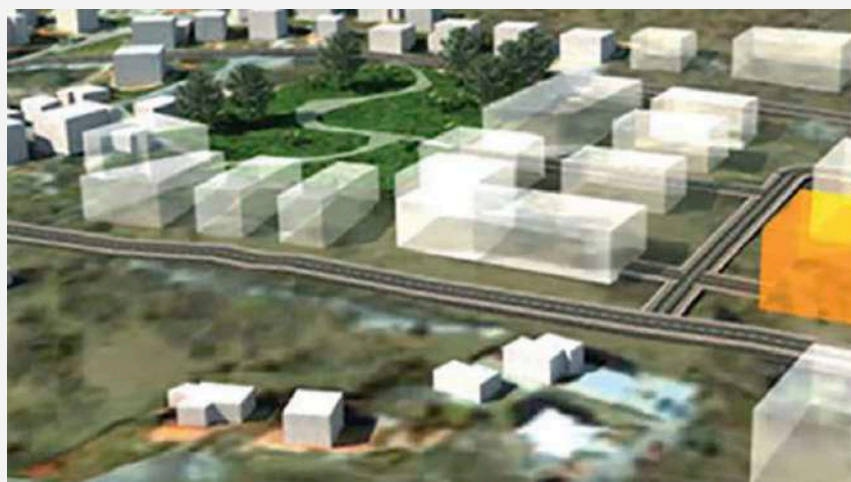

INVESTMENT PROJECT PROFILE



Project title	Na Aveniji – Residential Neighbourhood
Location	City of Rijeka – area of Trsat
Project ownership leader	City of Rijeka
Project description	<p>The future residential complex is envisaged by the Detailed Development Plan for the area of Trsat Residential District (SN 29/09) and Detailed Development Plan for the University Campus and University Clinical Hospital on Trsat (SN 29/05), entirely built on an empty land plot at the north-eastern edge of Trsat. This is a very attractive residential area of the City of Rijeka, recognisable by its medieval core, family buildings surrounded by vegetation, extremely good view of Rijeka bay and the islands but also by the Campus and University Clinical Hospital complex currently under construction. Due to the aforementioned qualities, a new residential construction of mostly multi-family housing units is being developed, while along the University Avenue multiple attractive multi-family units have already been built, and the residential neighbourhood which is the subject of this project shall be an extension thereof.</p> <p>The project involves the following construction activities:</p> <ul style="list-style-type: none">• 9 multi-housing and multi-family units, ground floor + 2 storeys and ground floor + 4 storeys high, 13,600 m² maximum gross built area of the residential area (above ground)• public surfaces—roads and public park (responsibility of the City)
Estimated value of the project	17.000.000 EUR
Realization model	<p>The Conclusion of a preliminary contract/contract on the sale of land is being offered. The City of Rijeka is responsible for property and legal underpinnings and construction of roads with infrastructure.</p> <p>City of Rijeka issues a public tender for sale of land for the construction of residential buildings.</p>
For additional information about this project, please contact by e-mail: info@coral-consulting-service.com	